

Cindy Drozda
Box with Lid Inlay
Simple and Elegant



www.cindydrozda.com

Cindy Drozda's
Inlay Lid Box
Straight Sides, Flat Bottom

Copyright © Cindy Drozda
All rights reserved

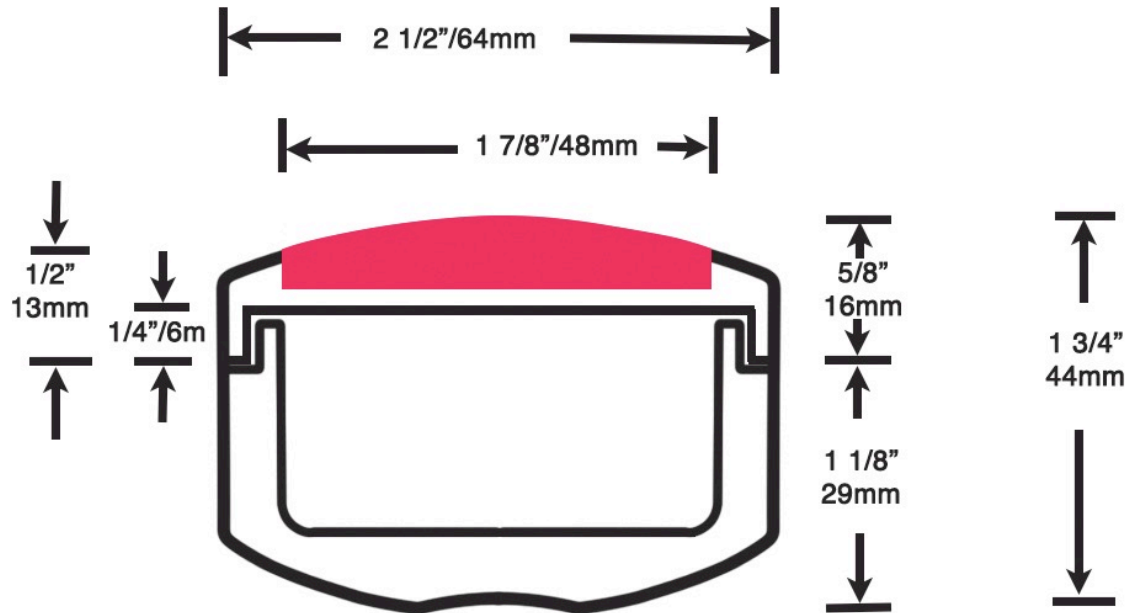

Box Diameter = 1.618 or $2/3$

Lid Height
1 or $1/3$

Box Height
1.618 or $2/3$

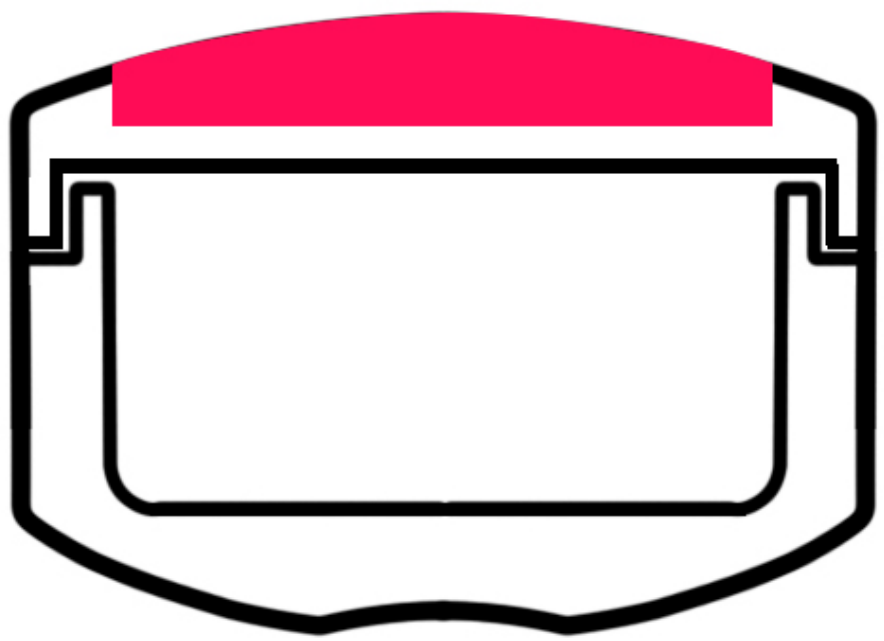

Total Height = 1
or $1/3$

Material Selection: Start with a piece of dry wood 2 1/2" x 2 1/2" x 2 1/4" (or similar).

ough between centers, and turn a 1/4" long chucking point on each end.

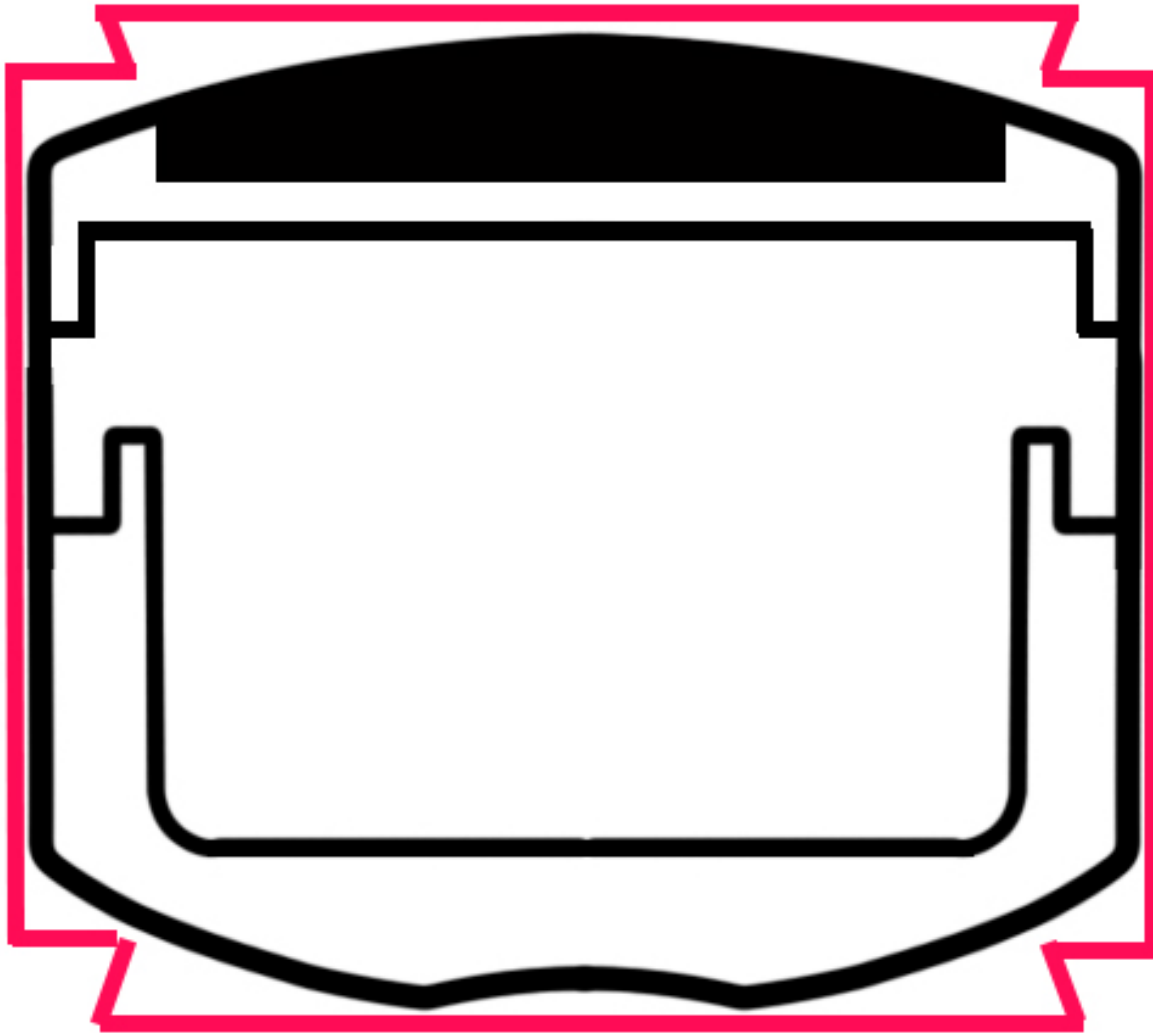

Top of box in the chuck. Part off bottom of box.

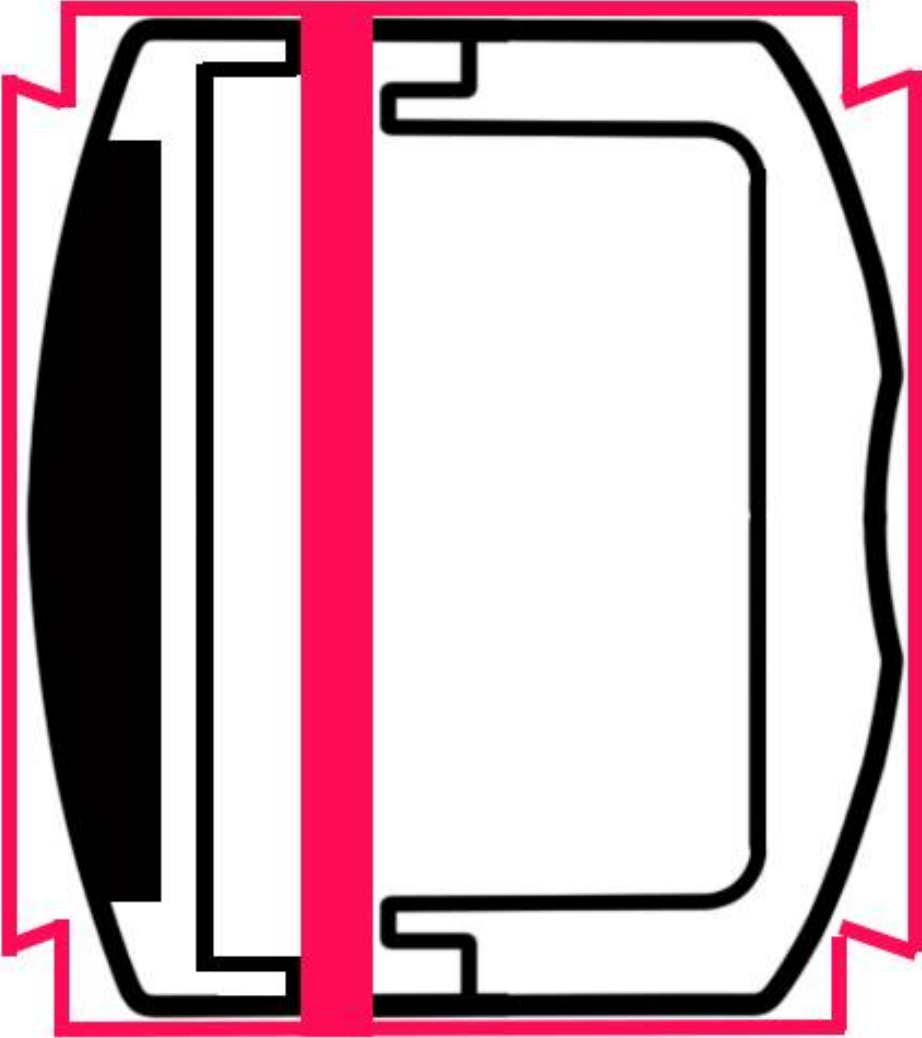

↓
1/2"
13mm
↑



Create a recess about 1/4" deep in lid for fitting onto bottom of box.

Shape, sand, and finish inside of lid.



Bottom of box in chuck. Flatten end of block and friction drive the flat inlay disk. Size the disk to the desired diameter of your inlay. Disk should have parallel sides and flat face (up to the tail center). Leave a shoulder on inlay disk to make it easier to handle.

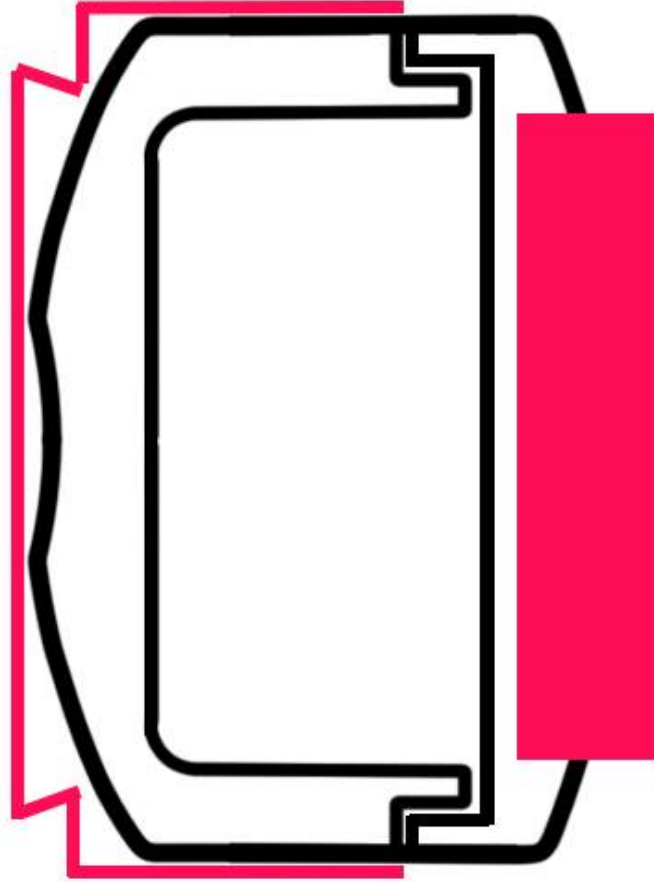

Transfer lid recess diameter to face of box bottom blank. Create a tenon on box bottom to jam fit lid onto. Recess inlay disk into top of lid.

Shape top of lid and inlay.

Sand and finish top of lid and inlay

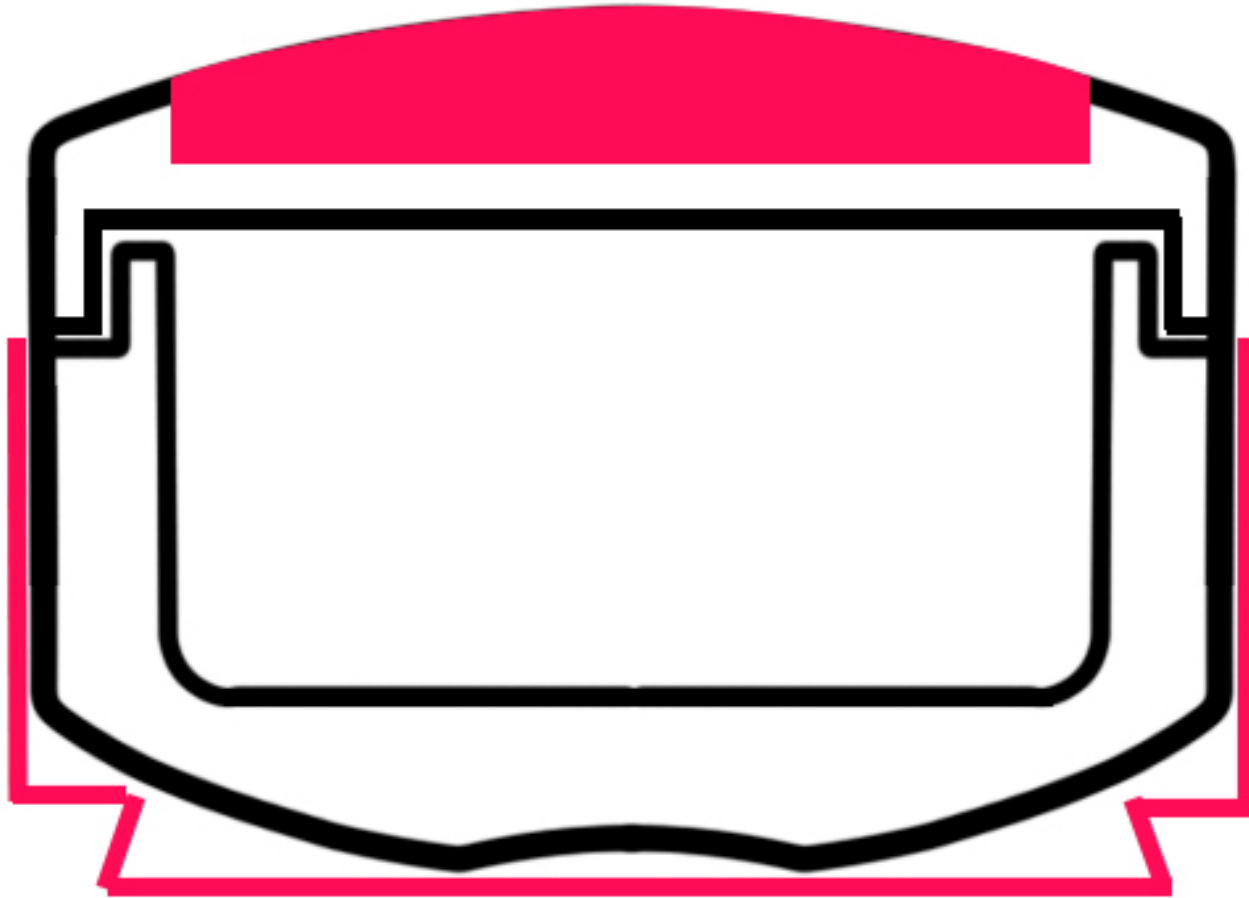

Detail around inlay if desired.

If desired, form a bead on the inlay.

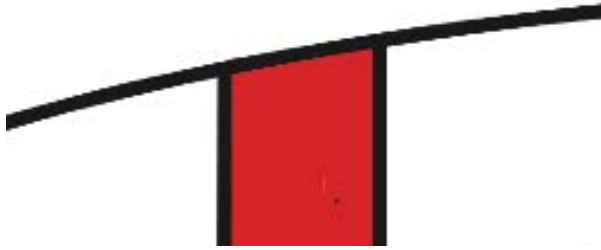

1 – The flush inlay



2 – Make a Vee Groove on the joint lines



3 - Facet the top corners of the Vee Grooves



4 - Sand into a round bead shape

**Hollow the box, sand and finish inside of box.
Re-cut lid fit tenon if necessary to get the fit that you want**

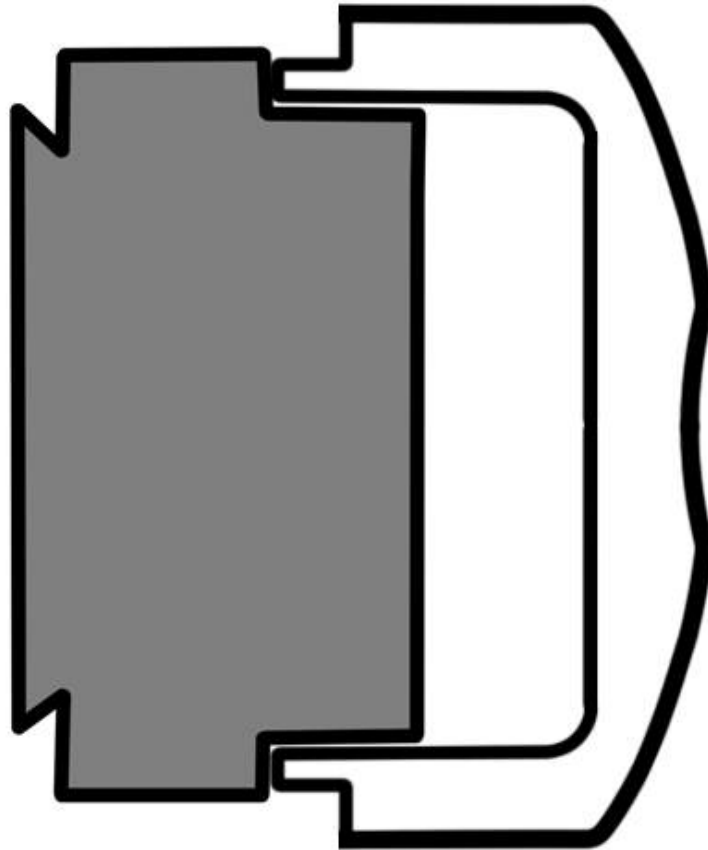

**Mount a waste block in the chuck.
Caliper inside of box bottom, transfer onto waste block.
Cut a tenon on the waste block to jam fit box.**

**Shape, sand, and finish box bottom.
A slight undercut at the base allows the box to sit flat.**

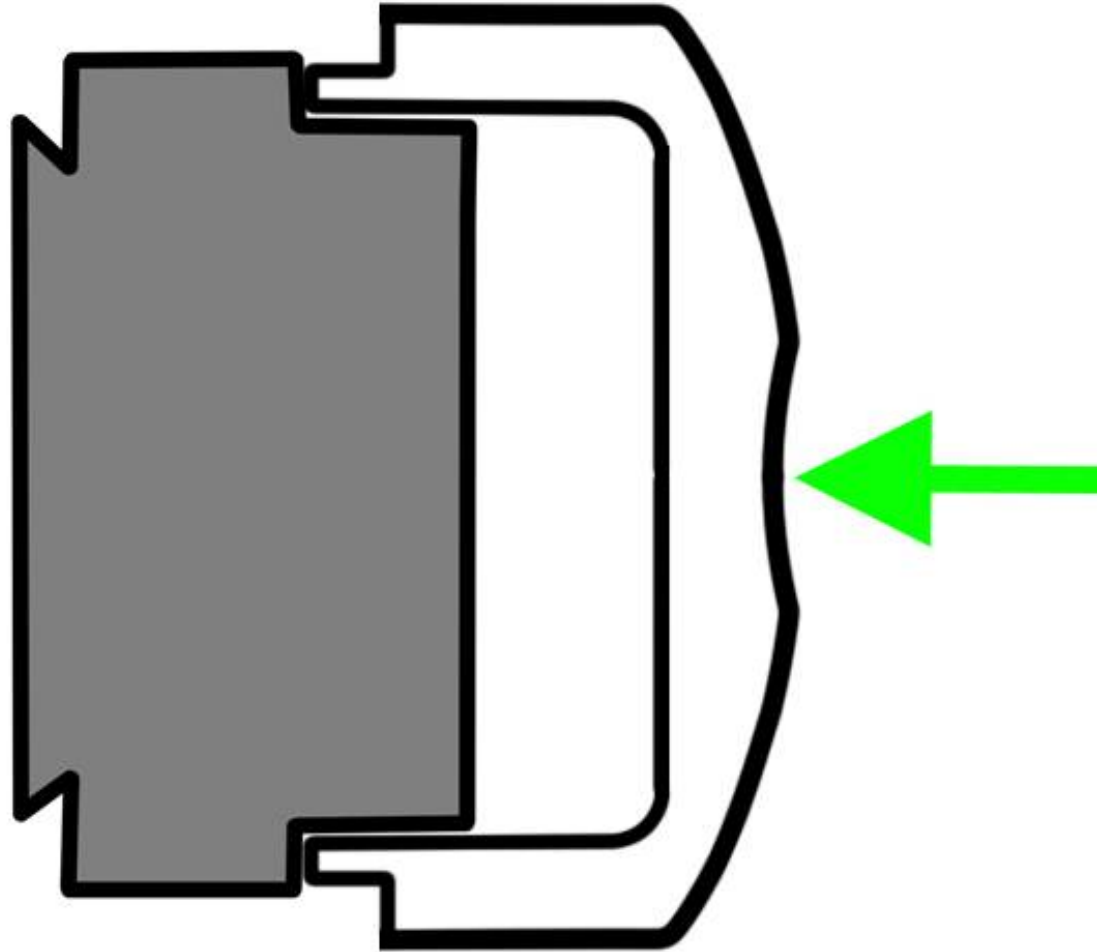

Sign your work. Congratulations! You're done!